

1500 – 1750 – 1750HD – 2000 – 3500KG

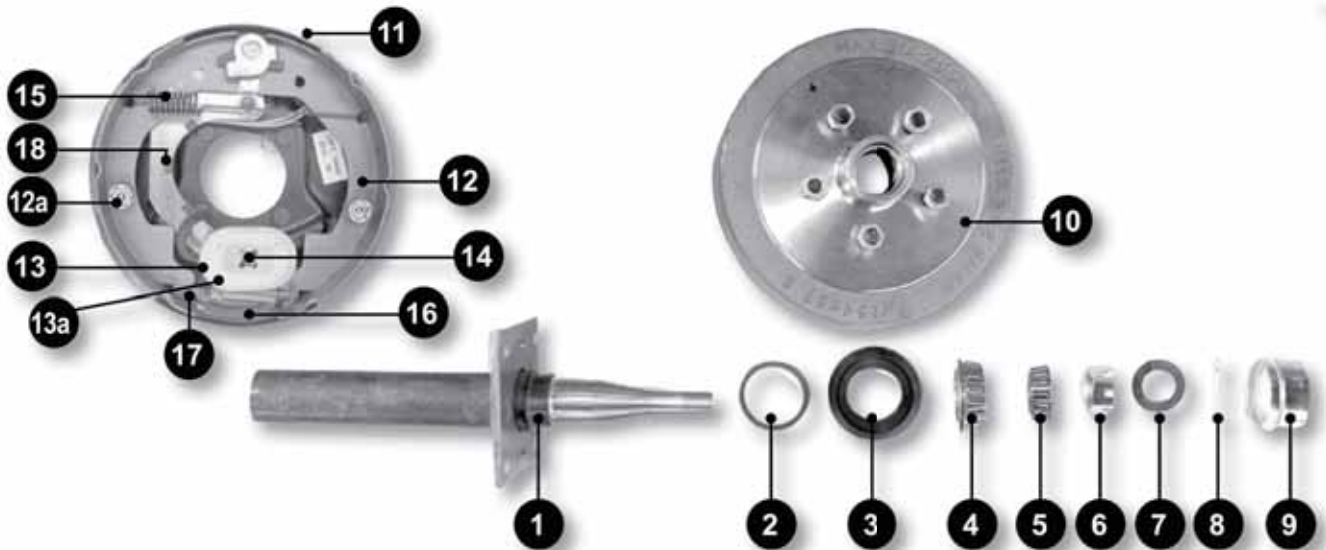

ITEM	DESCRIPTION	1500KG 10" x 2.25"	1750KG 10" x 2.25"	175 OH/D 10" x 2.25"	2000KG 12" x 2"	3500KG 12" x 2"
1	Axle	TE192206	TE192208	TE192209HD	TE192209	TE192210
2	Washer Marine Seal Only	TE190144	—	—	—	—
3	Seal 2 Lip	TE190142	TE190146	TE190146	TE190148	TE190151
	Marine Seal	TE190143	TE190145	TE190145	—	—
4	Bearing Inner	"TE190189-21 LM67048/10	TE190189-23 L68149/10	TE190189-23 L68149/10	TE190189-26 25580/20	TE190189-16 30210
5	Bearing Outer	"TE190189-20 LM11L949/10	TE190189-22 LM12749/10	TE190189-23 L68149/10	TE190189-21 LM67048/10	TE190189-24 LM29748/10
6	Slotted Nut	TE190178	TE190178	TE190180	TE190180	TE190182
7	Washer	TE190190-08	TE190190-08	TE190190-10	TE190190-10	TE190190-11
8	Split Pin	M4X32	M4X32	M5X63	M5X63	M5X63
9	Dust Cap	TE190161	TE190161	TE190168	TE190168	TE190171
10	Brake Drum	TE192226Z	TE192226Z	TE192229	TE192241- 2000kg	TE192241- 3500kg
	Brake Drum Hub	—	—	—	TE192230	TE192240
11	Back Plate c/w Park L/H Brake R/H	TE192273LPC TE192273RPC	TE192273LPC TE192273RPC	TE192273LPC TE192273RPC	TE192275L TE192275R	TE192275L TE192275R
	Back Plate c/w Park Galv type L/H Brake R/H	TE192274LPGC TE192274RPGC	TE192274LPGC TE192274RPGC	TE192274LPGC TE192274RPGC	—	—
12	Brake Shoe - Dexter - CM	TE192280 TE192280-C	TE192280 TE192280-C	TE192280 TE192280-C	TE192281	TE192281
12a	Brake Shoe Retainer Set	TE192279	TE192279	TE192279	—	—
13	Magnet Assy - Standard - New Heavy Duty	TE192292 —	TE192292 —	TE192292 —	TE192293 TE192293HD	TE192293 TE192293HD
13a	Magnet Spring	TE192291-04	TE192291-04	TE192291-04	TE192293HD	TE192293HD
14	Magnet Clip	TE192291-01	TE192291-01	TE192291-01	TE192291-01	TE192291-01
15	Spring Top	TE192290-10	TE192290-10	TE192290-10	TE192290-12	TE192290-12
16	Spring Bottom	TE192289	TE192289	TE192289	TE192289	TE192289
17	Adjuster Assembly	TE192286	TE192286	TE192286	TE192286	TE192286
18	Cable Clip	TE192291-03	TE192291-03	TE192291-03	TE192291-03	TE192291-03
19	Cable Grommet	TE192291-02	TE192291-02	TE192291-02	TE192291-02	TE192291-02