

# 1500 – 1750 – 2000 – 3500KG TWO-PIECE ROTOR

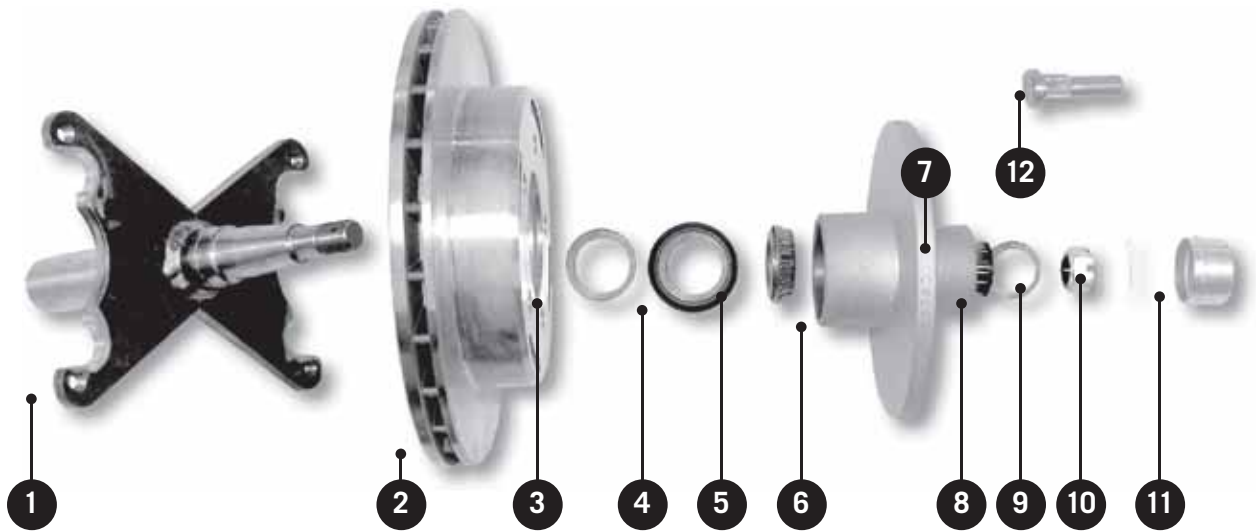

	DESCRIPTION	1500KG	1750KG	2000KG	3500KG
1	Axle Single Mount	TE192212-K	TE192215-K	TE192218-K	—
	Axle Twin Mount	TE192212-KD	TE192215-KD	TE192218-KD	TE192220-KD
2	Rotor SCAD Plated	TE192KR0TOR10	TE192KR0TOR10	TE192KR0TOR10	TE192KR0TOR12
	Stainless Steel	TE192KR0TOR10SS	TE192KR0TOR10SS	TE192KR0TOR10SS	TE192KR0TOR12SS
3	Washer Marine Seal	TE190144	—	TE190147-2	—
4	Marine Seal	TE190143	TE190145	TE190147-1	TE190151 M
5	Bearing Assembly Inner	TE190189-21	TE190189-23	TE190189-24	TE190189-16
		LM67048/10	L68149/10	LM29748/10	30210
6	Hub	POA	POA	POA	POA
7	Bearing Assembly Outer	TE190189-20 LM11949/10	TE190189-22 LM12749/10	TE190189-09 30205	TE190189-24 LM29748/10
8	Washer	TE190190-08	TE190190-08	TE190190-08	TE190190-11
9	Slotted Nut	TE190178	TE190178	TE190178	TE190182
10	Split Pin	TE190190-01	TE190190-01	TE190190-01	TE190190-03
11	Dust Cap	TE190161 1.78"	TE190161 1.78"	TE190164 52mm	TE190171 3"
12	Wheel Stud <sup>7</sup> / <sub>16</sub> UNF	TE8WS07-K	TE8WS07-K	—	—
	<sup>1</sup> / <sub>2</sub> UNF	TE8WS08-K	TE8WS08-K	TE8WS08-K	< 10/08 TE8WS08-2.25L 10/08 > TE8WS08-2.0

\* Please advise stud pattern required