

MASTER CYLINDER & BRACKET ASSEMBLY

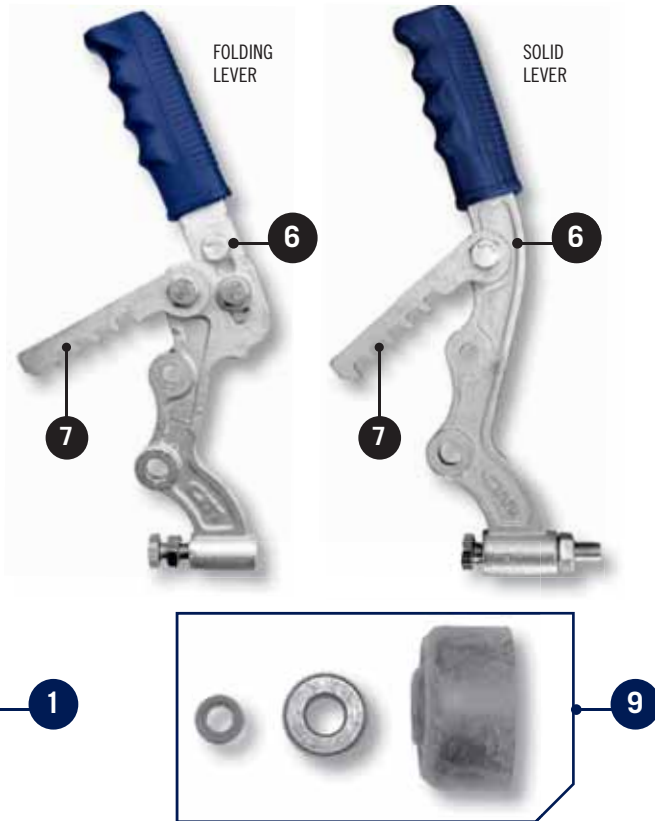
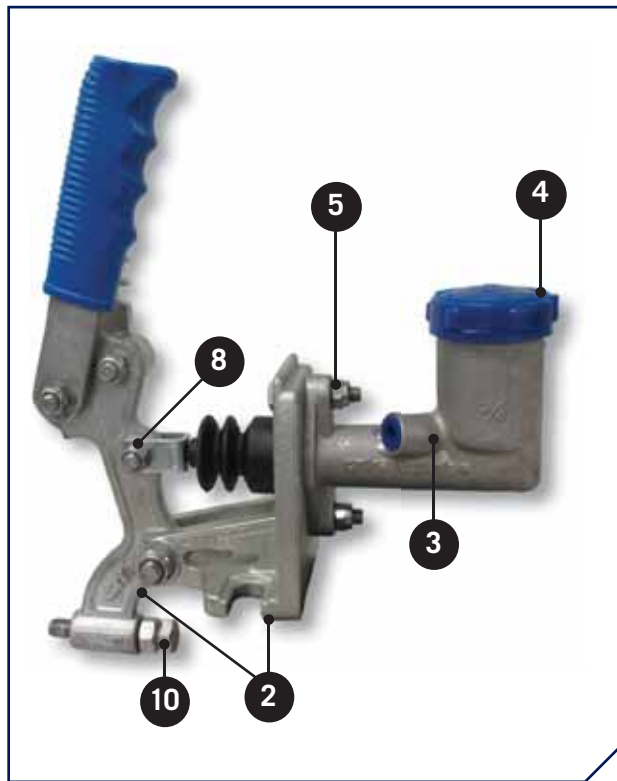

SPARE PARTS

ITEM	DESCRIPTION	SOLID LEVER	FOLDING LEVER
1	$\frac{3}{4}$ Master Cyl & Bracket Assembly Complete	Obsolete, now use TE194425FZ	TE194425FZ
	$\frac{7}{8}$ Master Cyl & Bracket Assembly Complete	Obsolete, now use TE194427FZ	TE194427FZ
2	Bracket & Lever Assembly	Obsolete, now use TE194424FZ	TE194424FZ
3	$\frac{3}{4}$ Master Cylinder with 5° port (pictured)	TE194436	TE194436
	$\frac{3}{4}$ Master Cylinder Assembly (standard 45° port)	TE194437	TE194437
	$\frac{7}{8}$ Master Cylinder Assembly (standard 45° port)	TE194438	TE194438
	1" Master Cylinder Assembly (standard 45° port)	TE194439	TE194439
4	$\frac{3}{4}$ Master Cylinder Cap	TE194440	TE194440
	$\frac{7}{8}$ Master Cylinder Cap	TE194441	TE194441
	$\frac{7}{8}$ Master Cylinder Cap (Alloy Body)	TE194440	TE194440
	1" Master Cylinder Cap (Plastic Body)	TE194443	TE194443
5	Bolt & Nut	M8x30x2	M8x30x2
6	Handbrake Lever & Ratchet Assembly	Obsolete, now use TE194422FZ	TE194422FZ
7	Handbrake Ratchet/Pin/Spring	TE194423	TE194423
8	Bolt & Nyloc Nut	M8x25	M8x25
9	$\frac{3}{4}$ Master Cylinder Kit	TE194444	
10	Adjuster bolt & Nut	M10 x 60" $\frac{5}{16}$ UNC	M10 x 60" $\frac{5}{16}$ UNC