

SELF CENTRE ROLLERS

TE16A525



TE16A505



TE16A510
Aluminium



PART NO	COLOUR	A	B	C	D	BORE DIAMETER
TE16A20	Black	70mm	45mm	30mm	155mm	17mm
TE16A21	Black	70mm	50mm	36mm	190mm	17mm
TE16A525	Black	72mm	43mm	48mm	300mm	20mm
TE16A505	Black	72mm	43mm	48mm	380mm inc shaft	15.9mm shaft
TE16A510	Aluminium	72mm	43mm	48mm	285mm	20mm

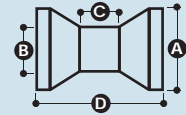

STAINLESS STEEL ROLLER PINS

Supplied with stainless steel split pins.



PART NO	A	B	C	SUITS ROLLER
TE16P16110	98mm	110mm	16mm	TE16A01
TE16P16140	128mm	140mm	16mm	TE16A02 / TE16A25
TE16P16150	138mm	150mm	16mm	TE16A03
TE16P16190	178mm	190mm	16mm	TE16A04
TE16P16200	188mm	200mm	16mm	TE16A05 / TE16A20 / TE16A26 / TE16A10
TE16P16240	228mm	240mm	16mm	TE16A06 / TE16A11 / TE16A15 / TE16A21
TE16P19240	228mm	240mm	19mm	TE16A27
TE16P19350	336mm	350mm	19mm	TE16A12 / TE16A16 / TE16A525 / TE16CON44

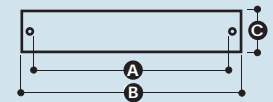

WOBBLY ROLLERS

PART NO	COLOUR OF TYRE/HUB	DIAMETER	WIDTH	BORE DIAMETER
TE16A40B*	Blue/Black	105mm	85mm	24mm
TE16A44	Grey/Blue	128mm	74mm	26mm

* Requires steel spacer TE1916SP to 'pack out' when using on CM Wobble Roller Kits



Smooth: TE16A40B*



Ribbed: TE16A44